

MR



Performance Data

Maximum Flow	8,5 l/min
Maximum Vacuum	-813 mbar
Maximum Pressure	1400 mbar ^[1]
Maximum vacuum Start up	-813 mbar
Maximum pressure Start up	1400 mbar

^[1] Available under request for maximum pressure up to 2200 mbar

Motor Data

Motor Type	DC Brushed
Voltage	12 Vdc 24 Vdc
Maximum current	1.50 A 0.70 A
IP	50
Insulation Class	E
Electrical Connection	2 wire length 290 mm

Additional Data

Average Noise	57 dB
Weight	560 g

Vacuum / Flow characteristic

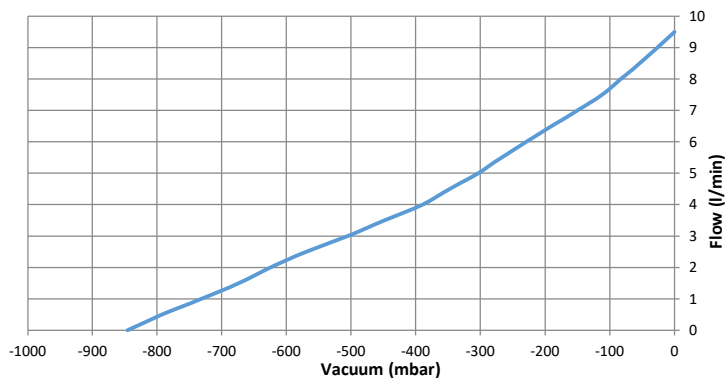

DIAPHRAGM PUMP FOR AIR/GAS APPLICATION

Attributes

100% Oil-free
Excellent gas sealing / Contamination free
Optimal flow to size ratio
Low power consumption and noise level
Quick and easy maintenance procedure
Pump Re-Start at max levels

Applications

Aspiration (surgical, welding)
Small portable equipment
Environmental sampling
Laboratory analysis
Laser cutters
Pick and place, transport
Vacuum-therapy

Dimensions in mm

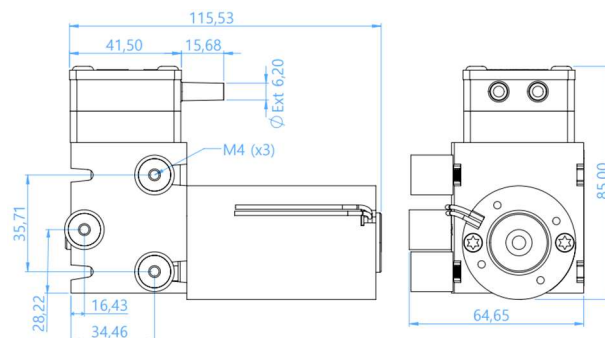

Available Material Options

Head	PPS
Diaphragm	FKM (alternatives on request)
Valve	FKM (alternatives on request)
O-Ring	VMQ (alternatives on request)

Service kits

RUBBER KIT H/S5 M/SR P&N	900.12
--------------------------	--------

Pressure / Flow characteristic

