

H10



Performance Data

Maximum Flow	16 l/min (+0,5 l/min @60Hz)
Maximum Vacuum	-760 mbar
Maximum Pressure	1400 mbar
Maximum vacuum Start up	ATM
Maximum pressure Start up	ATM

Motor Data

Motor Type	AC shaded pole
Voltage	230 Vac 50Hz 120 Vac 60 Hz
Maximum current	0,7 A 1,3 A
IP	00
Insulation Class	B (120°C Th. Protection)
Electrical Connection	Male 6.3 x 0.8mm tab (L+N)

Additional Data

Average Noise	56 dB
Weight	1770 g

DIAPHRAGM PUMP FOR AIR/GAS APPLICATION

Attributes

100% Oil-free
Excellent gas sealing / Contamination free
Long reliable service life
Low power consumption and noise level
Quick and easy maintenance procedure
Exceptional motor lifetime
Excellent flow/size ratio

Applications

Aspiration (surgical, welding)
Scenting
Environmental sampling
Laboratory analysis
Laser cutters
Pick and place, transport
Vacuum-therapy

Dimensions in mm

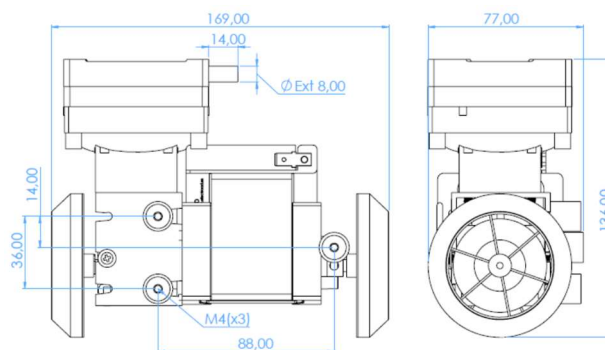

Available Material Options

Head	PPS (alternatives on request)
Diaphragm	EPDM (alternatives on request)
Valve	FKM (alternatives on request)
O-Ring	VMQ (alternatives on request)

Service kits

Ask for availability N/D

Vacuum / Flow characteristic ^[1]

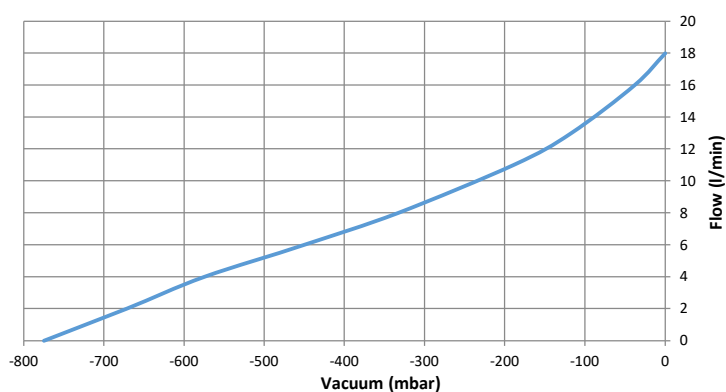

Pressure / Flow characteristic ^[1]

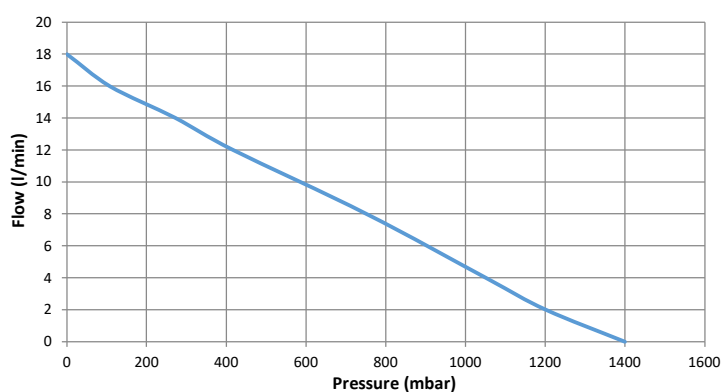

[1] Characteristics shown for frequency (f) at 50Hz. At f=60Hz starting flow increases +0,5 l/min.