

Oil-Free  
Explosion Proof Pump

# EX SERIES

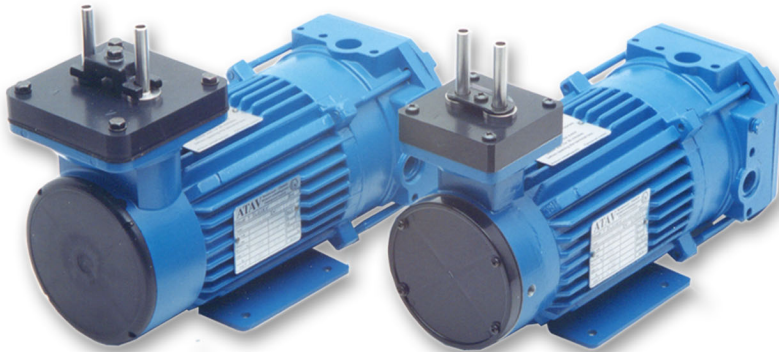

Max Flow	17 l/min
Max Vacuum	560 mm Hg
Max Pressure	2.5 bar

**Contamination free pumping**

EX series pumps provide a clean oil free vacuum and pressure source in potentially explosive environments. Suitable for continuous duty the EX series is ideal for use in petrochemical industry where class IIC certification is required.

**Adaptability and long life**

The robust construction of the EX series ensures long term reliability even in continuous duty applications. EX series pumps are available for 110v or 230v supply ensuring suitability for world-wide operation. The pump performance can be customised to suit each client's requirements.

**Fully explosion proof**

Designed for use in the sampling and process control industry where explosive gases are present the EX series incorporates an explosion proof motor, for certified installation in zone 1 and zone 2 areas to the enclosure group class EExd T4 IIC.

**Corrosion resistant options**

The EX series can be upgraded with a range of optional material components providing resistance to a wide range of corrosive gases and vapours

**Application ideas**

Application ideas include gas monitoring, hazardous area sampling, chemical processing and for use in the printing industry.

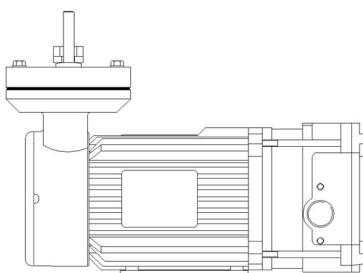

EX30 single ended pump

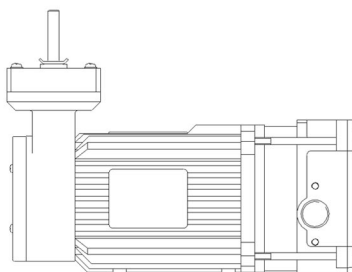

EX7 single ended pump

**EX30**

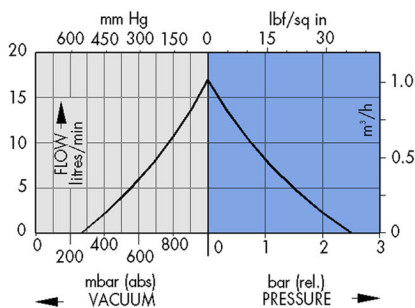

**EX7**

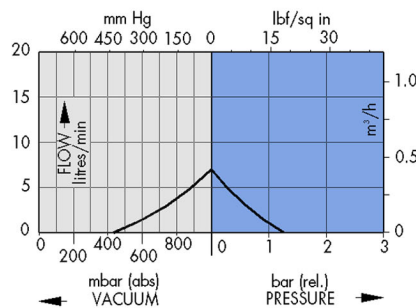

# EX SERIES

### Motor Type:

IP55. Totally enclosed permanent capacitor explosion proof. 1450 RPM.

Electrical Connection: M20 Thread for cable gland

model no.	110/115V 50/60Hz			230V 50Hz		
	operating current	max. load	fuse rating	operating current	max. load	fuse rating
EX7	1.2A	2.0A	3.0A	0.7A	0.9A	2.0A
EX30	1.2A	2.0A	3.0A	0.7A	0.9A	2.0A

### Performance:

model no.	max. free flow l/min	max. vacuum mbar (abs)	max. pressure bar
EX7	7.0	440	1.2
EX30	17.0	560	2.5

### Connectors:

Plain, vertical, stainless steel 8.0mm OD  
 Optional: plain, verticle, stainless steel 6.0, 6.4 mm OD  
 barbed, verticle, PTFE, 8.0mm OD

**EX7** 6.5kg

dimensions: mm

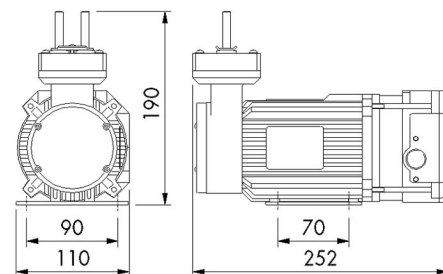

### Pump Materials:

With the option of appropriate materials for the head and flexibles, EX pumps will handle a wide range of corrosive gases.

component	standard	options
Head	aluminum	stainless steel, PTFE coated aluminum
Diaphragm/Valves	EPDM/Nitrile	PTFE, Viton
Connectors	stainless steel	PTFE
'O' Rings	Nitrile	PTFE, Viton

**EX30** 6.9kg

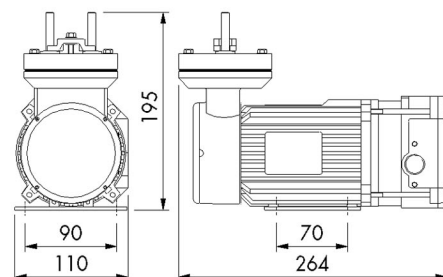

distributed by:

Please note that it is important that you ensure the motor specification stated and the range of materials offered in the pump are compatible with the performance, environmental limitations and chemical resistance of the application.

For further information or details of our extensive range of diaphragm pumps, contact our technical sales office who will be pleased to help you select the most suitable pump for your application.

S30-227/2